



## AVOL Model J3-4200 Motorised Stainless Steel Ball Valve

### Electrically operated 2 way 316SS PN16 ball valve, fire-safe and anti-static

Full bore fire-safe and anti-static 2 way 316 stainless steel ball valve, flanged PN16, designed for automation with integrally cast ISO5211 actuator mounting platform fitted with direct mounted J3 electric actuator. Supplied assembled and dry bench function tested. Size range from 1/2" to 6".



Code	Function
J3-4203	Standard power to open - power to close - Stays put on mains failure
J3-4204	Failsafe BSR - Battery Spring Return - Fails to safe position using an internal battery
J3-4205	Modulating DPS - Digital Positioning System

#### Applications

Water, oil and many corrosive medias, subject to compatibility with wetted parts in contact with media. Actuators sized on a maximum differential pressure of 10 bar wet service, if the intended duty is above this differential, or dry (air or gas) call to check actuator sizing as a larger output actuator may be required.

Maximum working temperature of assembly is +70C. If the intended duty is a higher temperature than this, select model J3-4210 which has a mounting kit between the valve and actuator which uses air cooling to dissipate the heat away from the actuator (standard kit: maximum +130C).

#### Valve Specification

Body	CF8M Cast 316SS
Ball	CF8M Cast 316SS
Seats	RTFE
Pressure rating	PN16
Valve temp limits	-20 to +200°C
Actuator temp limits	-20 to + 70°C



#### Quick guide to the J3 electric actuator standard features :

Highly visible LED light gives continuous actuator status indication.

J3 L - 12-24V AC/DC

J3 H - 80-240V AC/DC

Multi-voltage capable with auto-voltage sensing:

Torque output: range:  
25~95Nm Break  
20~80Nm Reseat

Electronic torque limiter  
Protects against valve jams

Anti-condensation heater

Manual override

All connections via external DIN plugs ~ no need to remove cover to connect

Volt free end of travel confirmation switches

IP65 weatherproof housing

CE marked

Traceable sequential serial numbering system

Optional failsafe kit (Battery Back-up) - actuator fails to safe position on power failure

Optional modulating kit with digital positioning system, either 0-10V or 4-20mA

#### J3 Actuator status light basic function:

Constantly lit LED

The LED flashes with 2 blinks

The LED flashes on/ off

If the actuator is operating correctly with no faults, the LED shows a constantly lit light.

If the actuator has been left in 'manual' mode, the actuator's motor runs but doesn't drive the output shaft. After a pre-set time, the actuator knows that as the torque limiter has not activated and that the motor is running, it is in manual.

When the actuator senses an impending valve jam, the electronic torque limiter is activated and on activation, repeatedly flashes the LED on and off.





# AVOL Model J3-4200

## DIMENSIONS

Electrically operated PN16 flanged fire-safe stainless ball valve - Dimensions (to nearest mm)

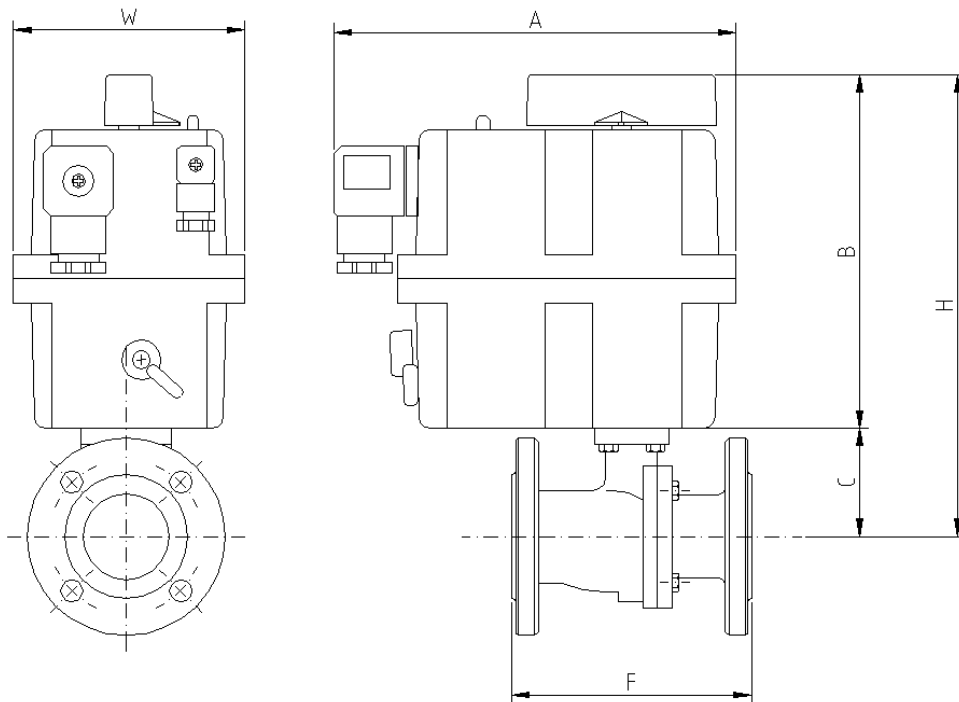

Dimensions remain unchanged for all versions (on-off, failsafe & modulating)

	Model	A	B	C	F	H	W	Kilos
1/2"	20	177	149	49	115	198	110	4.0
3/4"	20	177	149	54	120	203	110	4.6
1"	20	177	149	59	125	208	110	5.4
1 1/4"	20	177	149	73	130	222	110	7.3
1 1/2"	35	177	171	89	140	260	110	12.0
2"	35	177	171	97	150	268	110	16.4
2 1/2"	85	177	196	116	170	312	110	21.6
3"	<b>J2</b> -140	235	254	133	180	387	214	32.5
4"	<b>J2</b> -300	235	254	157	190	411	214	58.7